

连平县2021年度第八批次城镇建设用地勘测定界图

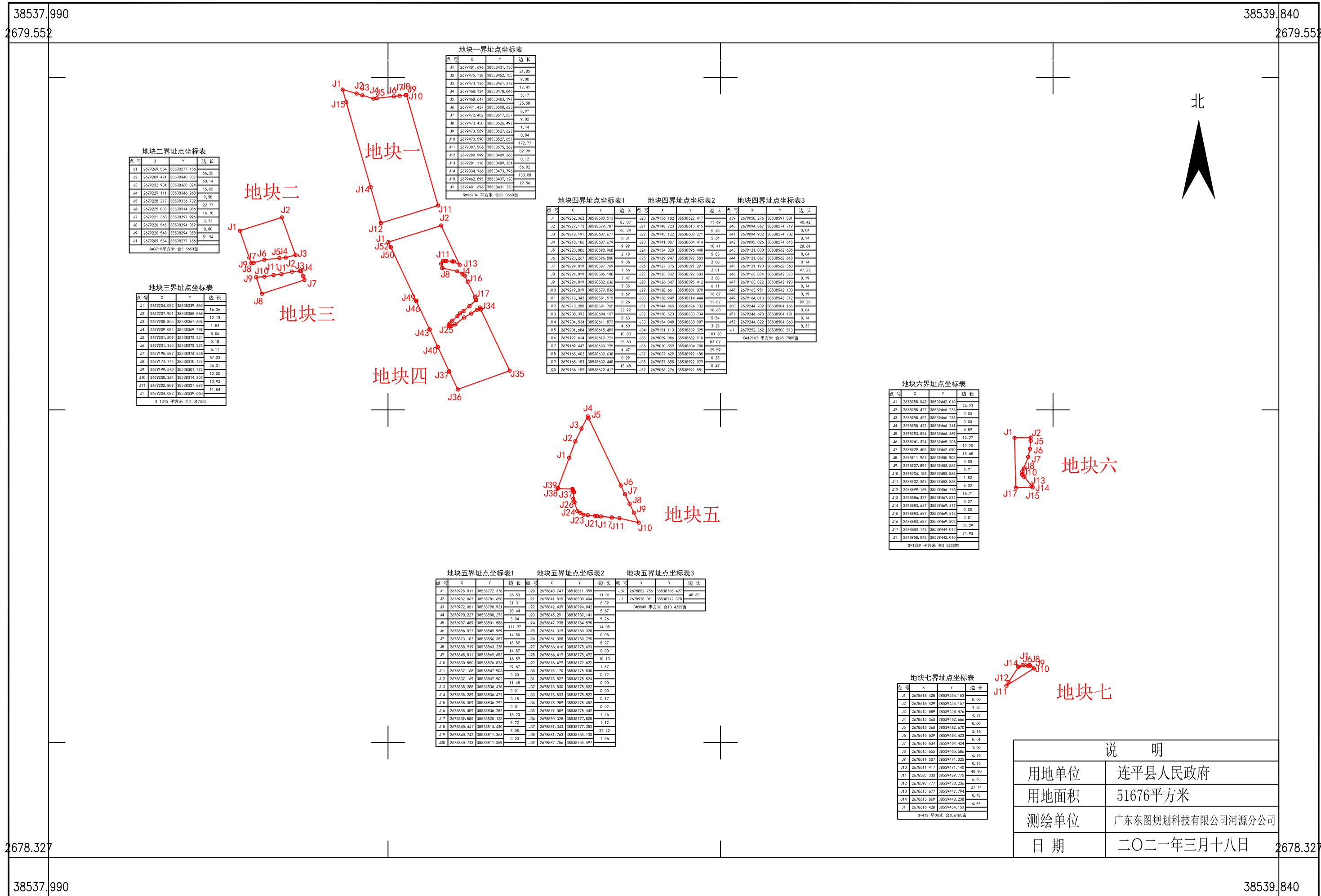

地块二界址点坐标表

点号	X	Y	边长
J1	267929.554	38538277.154	66.25
J2	267929.471	38538340.337	60.14
J3	2679232.931	38538346.624	15.05
J4	2679229.111	38538346.288	9.58
J5	2679228.217	38538336.732	22.77
J6	2679225.833	38538314.086	16.70
J7	2679221.363	38538297.996	3.73
J8	2679220.545	38538294.389	0.00
J9	2679220.548	38538294.389	51.94
J1	267929.554	38538277.154	

S=710平方米 合5.54亩

地块三界址点坐标表

点号	X	Y	边长
J1	2679204.082	38538339.660	16.36
J2	2679207.901	38538355.568	12.13
J3	2679208.855	38538367.499	1.84
J4	2679209.084	38538369.489	8.06
J5	2679201.509	38538372.234	0.18
J6	2679201.330	38538372.275	6.11
J7	2679195.587	38538374.356	67.23
J8	2679174.744	38538310.437	26.31
J9	2679199.570	38538301.722	12.50
J10	2679200.264	38538314.205	13.92
J11	2679202.809	38538327.887	11.84
J1	2679204.082	38538339.660	

S=1345平方米 合2.0175亩

地块一界址点坐标表

点号	X	Y	边长
J1	2679481.696	38538431.730	21.85
J2	2679475.738	38538452.755	9.00
J3	2679473.126	38538461.372	17.41
J4	2679468.124	38538478.040	5.17
J5	2679468.447	38538483.191	25.58
J6	2679471.427	38538508.423	8.97
J7	2679472.402	38538517.517	9.02
J8	2679473.450	38538526.492	1.14
J9	2679473.589	38538527.422	0.04
J10	2679473.590	38538527.657	172.77
J11	2679307.566	38538575.262	89.99
J12	2679280.999	38538489.268	0.12
J13	2679281.118	38538489.234	56.02
J14	2679334.966	38538473.790	133.08
J15	2679462.895	38538437.120	19.56
J1	2679481.696	38538431.730	

S=6704平方米 合29.054亩

地块四界址点坐标表1 地块四界址点坐标表2 地块四界址点坐标表3

点号	X	Y	边长	点号	X	Y	边长	点号	X	Y	边长
J1	2679252.362	38538500.513	83.07	J20	2679156.182	38538622.417	11.69	J39	2679058.276	38538591.881	40.42
J2	2679277.173	38538579.787	65.24	J21	2679148.723	38538613.415	6.28	J40	2679084.867	38538574.719	0.04
J3	2679218.191	38538607.677	0.01	J22	2679145.122	38538608.271	5.64	J41	2679094.902	38538574.702	0.14
J4	2679218.186	38538607.679	9.99	J23	2679141.007	38538604.414	10.41	J42	2679095.026	38538574.645	28.64
J5	2679223.086	38538598.968	2.18	J24	2679134.320	38538596.440	5.82	J43	2679121.030	38538562.635	0.04
J6	2679223.267	38538596.800	9.06	J25	2679129.947	38538592.583	2.88	J44	2679121.067	38538562.618	0.14
J7	2679224.019	38538587.760	1.66	J26	2679127.375	38538591.297	2.01	J45	2679121.190	38538562.560	47.23
J8	2679224.019	38538586.108	3.47	J27	2679126.347	38538595.412	6.11	J46	2679163.884	38538542.373	0.19
J9	2679224.019	38538582.630	0.26	J28	2679126.347	38538595.412	16.87	J47	2679163.822	38538542.193	0.14
J10	2679219.819	38538579.834	6.69	J29	2679126.661	38538601.070	11.87	J48	2679163.951	38538542.133	89.26
J11	2679213.243	38538581.515	22.92	J30	2679138.949	38538614.444	10.43	J49	2679164.013	38538542.312	0.19
J12	2679213.288	38538581.760	0.26	J31	2679144.868	38538624.732	11.87	J50	2679244.709	38538504.155	0.04
J13	2679208.392	38538604.157	8.63	J32	2679150.523	38538633.734	10.63	J51	2679244.698	38538504.121	0.14
J14	2679204.524	38538611.870	4.60	J33	2679154.048	38538638.007	5.54	J52	2679244.822	38538504.063	8.33
J15	2679201.684	38538615.480	10.03	J34	2679151.111	38538639.395	101.80	J1	2679252.362	38538500.513	
J16	2679192.614	38538619.777	25.63	J35	2679109.086	38538682.910	83.07				
J17	2679169.447	38538630.725	4.47	J36	2679030.899	38538604.788	29.59				
J18	2679165.402	38538632.638	0.29	J37	2679057.629	38538592.185	0.25				
J19	2679165.183	38538632.448	13.48	J38	2679057.855	38538592.079	0.47				
J20	2679156.182	38538622.417		J39	2679058.276	38538591.881					

S=19167平方米 合28.754亩

地块六界址点坐标表

点号	X	Y	边长
J1	2678958.042	38539442.010	24.23
J2	2678958.422	38539466.233	0.00
J3	2678958.422	38539466.238	0.00
J4	2678958.422	38539466.241	4.89
J5	2678953.534	38539466.369	12.27
J6	2678941.324	38539465.206	12.20
J7	2678929.405	38539462.590	18.68
J8	2678911.961	38539455.903	4.55
J9	2678907.891	38539453.868	3.71
J10	2678904.183	38539453.868	1.82
J11	2678902.367	38539453.868	4.32
J12	2678899.168	38539454.776	16.71
J13	2678886.377	38539467.522	3.27
J14	2678883.437	38539469.317	0.00
J15	2678883.437	38539469.313	0.01
J16	2678883.637	38539469.302	25.29
J17	2678882.143	38539444.013	74.93
J1	2678958.042	38539442.010	

S=1389平方米 合2.0835亩

地块五界址点坐标表1 地块五界址点坐标表2 地块五界址点坐标表3

点号	X	Y	边长	点号	X	Y	边长	点号	X	Y	边长
J1	2678928.011	38538772.378	26.53	J20	2678840.743	38538811.399	11.01	J39	2678882.756	38538755.497	48.30
J2	2678952.867	38538781.650	21.31	J21	2678841.815	38538800.404	6.39	J1	2678928.011	38538772.378	
J3	2678972.051	38538790.921	30.44	J22	2678842.439	38538794.042	5.67				
J4	2678990.227	38538800.273	3.04	J23	2678845.291	38538789.141	5.26				
J5	2678987.489	38538801.586	111.97	J24	2678847.938	38538784.595	14.05				
J6	2678886.527	38538849.989	14.60	J25	2678861.319	38538780.320	0.08				
J7	2678873.182	38538856.387	15.62	J26	2678861.398	38538780.290	5.27				
J8	2678858.919	38538863.225	14.67	J27	2678866.416	38538778.693	0.00				
J9	2678845.011	38538869.653	16.59	J28	2678866.419	38538778.692	10.10				
J10	2678830.550	38538876.826	29.67	J29	2678876.479	38538779.622	1.87				
J11	2678837.168	38538847.906	0.00	J30	2678878.170	38538778.830	0.72				
J12	2678837.169	38538847.902	11.48	J31	2678878.827	38538778.524	0.00				
J13	2678838.288	38538836.478	0.01	J32	2678878.830	38538778.522	0.00				
J14	2678838.289	38538836.472	0.01	J33	2678878.833	38538778.522	0.00				
J15	2678838.309	38538836.292	0.18	J34	2678878.999	38538778.402	0.02				
J16	2678838.309	38538836.282	0.01	J35	2678879.009	38538778.442	1.46				
J17	2678839.885	38538820.126	16.23	J36	2678880.328	38538777.825	1.12				
J18	2678840.441	38538814.430	8.72	J37	2678881.343	38538777.382	22.22				
J19	2678840.743	38538811.363	3.08	J38	2678881.743	38538755.131	1.06				
J20	2678840.743	38538811.359		J39	2678882.756	38538755.497					

S=849平方米 合13.4235亩

地块七界址点坐标表

点号	X	Y	边长
J1	2678616.428	38539454.153	0.00
J2	2678616.429	38539454.157	4.35
J3	2678615.889	38539458.476	4.22
J4	2678615.365	38539462.666	0.00
J5	2678615.365	38539462.670	2.16
J6	2678616.629	38539466.423	0.01
J7	2678616.634	38539466.424	1.60
J8	2678615.655	38539466.686	6.76
J9	2678611.507	38539471.025	0.15
J10	2678611.417	38539471.140	48.90
J11	2678585.333	38539429.775	6.45
J12	2678590.777	38539433.236	27.14
J13	2678613.677	38539447.794	0.48
J14	2678613.869	38539448.238	6.44
J1	2678616.428	38539454.153	

S=112平方米 合0.618亩

说 明	
用地单位	连平县人民政府
用地面积	51676平方米
测绘单位	广东东图规划科技有限公司河源分公司
日期	二〇二一年三月十八日